



DECENTRALISED MECHANICAL EXTRACT VENTILATION



KEY FEATURES

BROOKVENT airstream DMEV is a discreet continuous running decentralised mechanical ventilation unit suitable for new build and refurbishment projects. The unique fan impeller design reduces turbulence to maximise airflow with minimal noise. Units can be wall or ceiling mounted directly to outside or through a short run of ducting.

- VERY QUIET
- REMOVAL OF INDOOR POLLUTANTS
- MULTI SPEED
- DESIGNED FOR CONTINUOUS RUNNING
- VERY LOW RUNNING COSTS
- EASY MAINTENANCE

- **IPX4** protection degree.
- **Aesthetic front flat cover** for modern interior design, easily removed for cleaning without the need of tools.
- **Aerodynamic deflectors** on the housing to reduce air turbulences and designed to maximise airflow.
- **Rigid optimised spigot** preventing distortion.
- **Low power consumption:** EC motor optimised for continuous running applications (24/24h).
- **Multi speed selection** to meet different ventilation requirements:
 - trickle speed: can be selected among 3 options either in case of air exhausting directly to the outside or of ducted installation;
 - boost speed (max speed).
 - available in Ø100mm and Ø150mm
- **Possible installation:** wall/panel, ceiling and window.
- **Totally recyclable plastic components**, environmentally friendly.
- **Double insulated:** no earth connection is required.
- **Tested to the latest standards:**
 - energy efficiency tested at independent laboratory BRE (UK).
 - designed and manufactured in accordance with EN60335-2-80 (Low Voltage Directive) and the EMC Directive (Electromagnetic Compatibility)

VERSIONS

Airstream DMEV

The unit runs continuously at the selected trickle speed. Boost speed is manually activated via remote switch or ambient sensor or via light switch.

Airstream DMEV HT

The unit is equipped with a humidity sensor (adjustable from 50% to 95% RH) and a timer (adjustable from ± 0' to 30'). Operation: when the percentage of relative humidity is higher than the pre-set threshold, the fan automatically increases speed. When the relative humidity goes beneath, the fan goes back running at the trickle speed after the over-run period is elapsed. The maximum speed can be manually activated via remote switch: a led indicates when the switch is on.

Airstream DMEV CF

The unit comes a constant flow mode. The airflow detection system will detect the installation duct resistance and also react to external wind conditions to ensure the fan maintains a constant extraction rate.

VERSIONS & DIMENSIONS (mm)

airstream DMEV 100 CF Product code: AF 90-DMEV-100CF
 airstream DMEV 100 Product code: AF 90-DMEV-100
 airstream DMEV 100 HT Product code: AF 90-DMEV-100HT
 airstream DMEV 150 HT Product code: AF 90-DMEV-150HT

Model	Weight	A	B	C	D	E
airstream DMEV 100	0.6 kg	164	70	46	116	99
airstream DMEV 150	1.2 kg	218	97	52	149	148

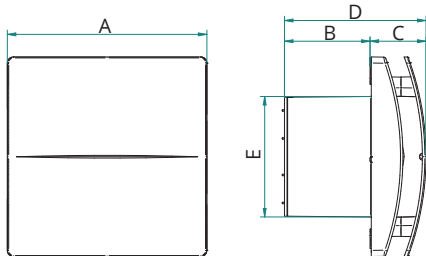

PERFORMANCE DATA

Model	airstream DMEV 100	airstream DMEV 150
Air-flow l/s	max 23.05 min 7.5/5.8 ⁽²⁾	max 51.9 min 8.05
Power consumption W	max 2.6 / 2.5 ⁽³⁾ min 1.0	max 6.5 min 1
Sound pressure db(A) @ 3m (1)	max 26 min 11	max 35 min from <9
Ambient temp. °C max	50	50
Degree of protection IP	X4	X4
Marking	CE	CE

- air performance measured according to ISO 5801 a 220-240V ~ 50Hz, air density 1,2Kg/m³.
 (1) sound pressure level @ 3m in free field, for comparative purposes only
 (2) 5.8 l/s refers only to constant flow version
 (3) 2,5W refers only to constant flow version

EXAMPLE OF A COMPLETE VENTILATION SYSTEM

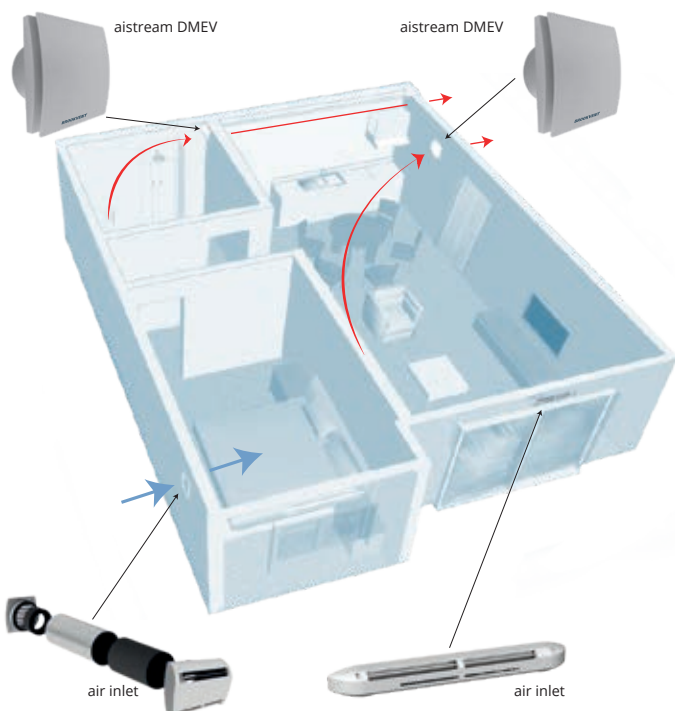

APPLICATION

Ideal solution in case of renovation.

How it works: the decentralised mechanical ventilation unit (Airstream DMEV) continuously extracts the stale air from the wet rooms directly to outdoor with the highest acoustic comfort.

Energy efficient: the EC brushless motor consumes a very low amount of electricity.

Indoor air quality: a correctly specified mechanical ventilation system can ensure the quality of the indoor air is constantly maintained for the health and well-being of the occupants as well as of the building.

PERFORMANCE CURVES

airstream DMEV 100, airstream DMEV 100 CF, airstream DMEV 100 HT

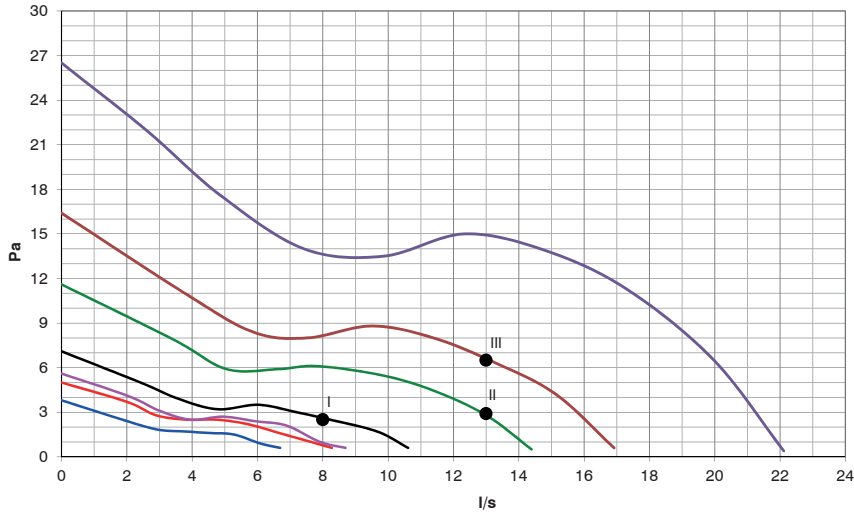

Curve	Setting ⁽²⁾	W max	I/s max
A	DP 001	1.0	7.50
B	DP 010	1.1	9.17
C	DP 101	1.1	9.72
D	DP 010	1.2	10.83
E	DP 011	1.5	14.72
F	DP 111	1.7	17.22
G	BOOST	2.6	23.06

(2) dp switch configuration on board

Working point	W	I/s max	SPI (W/I/s)	dB(A) @3m ⁽³⁾
I	0.8	8.06	0.0993	13
II	1.2	13.06	0.0919	21
III	1.7	13.06	0.1302	23

(3) sound pressure level: 3m in free field for comparative purposes only.

airstream DMEV 150 HT

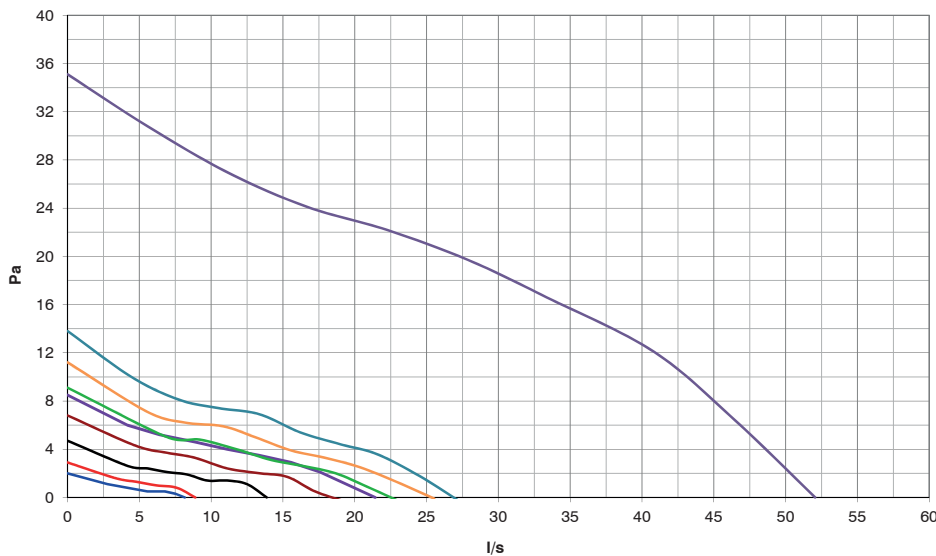

Curve	Setting ⁽²⁾	W max	I/s max
A	DP 000	1.0	8.06
B	DP 001	1.0	8.89
C	DP 010	1.2	13.89
D	DP 011	1.3	18.89
E	DP 100	1.3	21.39
F	DP 101	1.5	23.06
G	DP 110	1.7	25.56
H	DP 111	2.0	27.22
I	BOOST	6.5	51.94

(2) dp switch configuration on board

BROOKVENT™

Brook House
 Dunmurry Industrial Estate,
 City Business Park, Dunmurry,
 Belfast BT17 9HU
 T: +44 28 9061 6505
 F: +44 28 9061 6518

e-mail: info@brookvent.co.uk
brookvent.co.uk

